



ESPICHE GOLF FACT SHEET

COMPANY NAME: Espiche Campo de Golfe SA | VAT: 502 427 310

ADDRESS: Sítio dos Matos Brancos, 701-N, 8600-114 Espiche, Lagos - Portugal

TELEPHONE: Golf Reception: (+351 282 688 250 | Gecko Restaurant: (+351) 282 688 270

EMAIL: Golf Reception: reception@espichegolf.pt | Gecko Restaurant: gecko@espichegolf.pt

WEBSITE: www.espichegolf.pt

LOCATION (DIRECTIONS): From Lagos just follow the signs to Vila do Bispo/Sagres. At the next roundabout turn right into Espiche.

Once in Espiche just follow the orange "Golfe" signs until you see another sign for Espiche Golf on your right.

GPS COORDINATES: 37° 07'11.8" N | 8° 45'24.6" W

HEAD GREENKEEPER: Paulo Coelho

GOLF MANAGER: Pauline Binnie

COMMERCIAL DIRECTOR: Ana Santos Sequeira



THE COURSE

DESCRIPTION

Situated within a nature reserve and just ten minutes from Lagos, Espiche Golf is an eco-resort that has been perfectly integrated into the surrounding natural environment and offers a unique and authentic experience in the Western Algarve.

Preservation, conservation and innovation in resource management are at the heart of Espiche Golf. The 18 hole, par 72 golf course has been designed to integrate into the surrounding Algarve landscape and the indigenous flora and fauna of the area have been preserved, in keeping with the company's ethos of conservation and preservation. It is this commitment to the preservation of natural resources that we believe will allow Espiche Golf to continue to contribute to a sustainable future.

Course Designer / Architect: Peter Sauerman (South Africa)

Founded / Opening year: 2012

Holes: 18 / Par: 72

White Tees Length: 5890 metres

Yellow Tees Length: 5496 metres

Red Tees Length: 5009 metres

Greens: Paspalum cv. Sea Island 2000

Fairways: Bermuda (Cynodon dactylon cv. Tifton 419)

Tees: Bermuda (Cynodon dactylon cv. Tifton 419)

Handicap: Men < 28 | Ladies < 36

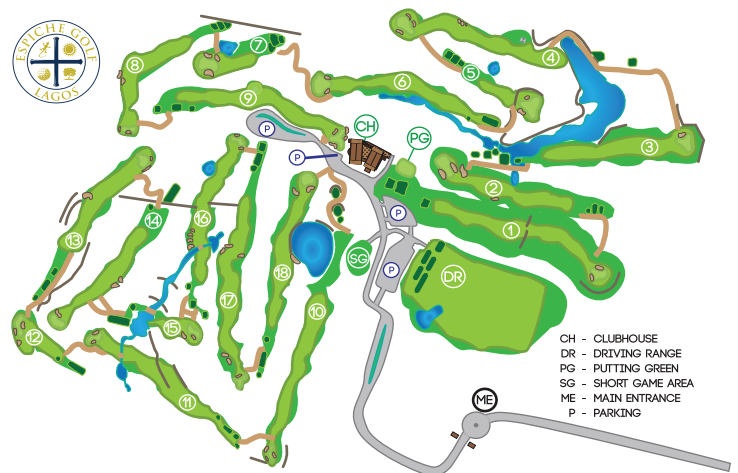

COURSE FACILITIES

DRIVING RANGE

Full driving range with turf and mats, practice putting green and short game area.

EQUIPMENT RENTAL

Quality sets of men's and ladies clubs for hire, both left and right handed.
We also have 45 buggies and electric or pull trolleys available.

PRO SHOP

Golf clothing, shoes, equipment and accessories are all available at the Espiche Golf shop.
We stock specially selected top quality brands and offer a premium range of golf products.

DRESS CODE

Appropriate golf attire is required for all players at all times. Soft spikes must be worn.

RECEPTION

Reception is open daily from 7.30am.
Reception closes between 6pm and 7pm throughout the year.

TUITION AND LESSONS

Our professional is available to provide instruction and tips to players of all levels and ages (full programme available).

LOCKER ROOMS

Separate men's and women's lockers, changing rooms and showers

BUGGY BAR

We provide a Buggy Bar service on the course with a variety of snacks and drinks for our players.

MEMBERSHIP

We offer a wide range of memberships at Espiche Golf, from our Junior Membership to our Annual or Overseas Membership. Discover all the benefits of becoming a member of Espiche Golf Club.



ESPICHE GOLF CLUBHOUSE

CLUBHOUSE

The Espiche Golf Clubhouse, which also houses the Gecko Restaurant, has won international awards for its architecture, design and environmental efficiency, both in terms of the choice of materials used in the building and its management of resources. The exceptional location of the Clubhouse, perched on a hill above the resort, offers breathtaking views of the golf course and nature reserve.

EVENTS

Espiche Golf is able to cater for a variety of different events and special occasions, with the course available for bespoke tournaments and the clubhouse open for a wide range of events including weddings, parties and corporate functions. Espiche Golf offers venue options to make your special occasion the event of your dreams.

AWARDS

2016: Finalist of the Real Estate "Oscars" 2016 by Imobiliário Magazine

2015: Clubhouse of the Year 2015 - 3rd place in the New Construction category by Golf Inc. Magazine

